



MEETING OF WADEYE LOCAL AUTHORITY

TUESDAY, 17 JULY 2018

The ordinary Meeting of the Wadeye Local Authority will be held on
(Tuesday, 17 July 2018) at 10:00am .

WEST DALY REGIONAL COUNCIL DISCLAIMER

No responsibility is implied or accepted by the West Daly Regional Council for any act, omission or statement or intimation occurring during Council or committee meetings.

The West Daly Regional Council disclaims any liability for any loss whatsoever and howsoever caused arising out of reliance by any person or legal entity on any such act, omission or statement or intimation occurring during Council or committee meetings.

Any person or legal entity who acts or fails to act in reliance upon any statement, act or omission made in a Council or committee meeting does so at that person's or legal entity's own risk.

In particular and without detracting in any way from the broad disclaimer above, in any discussion regarding any planning application or application for a licence, any statement or intimation of approval made by any member or officer of the West Daly Regional Council during the course of any meeting is not intended to be and is not taken as notice of approval from the West Daly Regional Council.

The West Daly Regional Council advises that anyone who has any application lodged with the West Daly Regional Council shall obtain and should only rely on **WRITTEN CONFIRMATION** of the outcome of the application, and any conditions attaching to the decision made by the West Daly Regional Council in respect of the application.



AGENDA

West Daly Regional Meeting

10:00am Tuesday 17 July 2018

WEST DALY REGIONAL COUNCIL REGIONAL OFFICE WADEYE

Welcome and Meeting Arrangements

Attendance and Apologies

Attendance

Apologies

Confirmation of Minutes

Wadeye Local Authority - 17 April 2018 3

Reports

1	Chief Executive Officer's Report	9
2	Regional Plan and Budget 2018/2019	12
3	Director of Council and Community Services's Report	13
4	Community Services Manager's Report	16
5	Nilinh Stage 2 Subdivision - Department of Infrastructure, Planning and Logistics.....	18
6	Finance Report	23
7	Local Authority Action Items Update	28

Questions from the Public

Next Meeting

Meeting Close

**MINUTES OF THE MEETING HELD IN THE WADEYE COUNCIL
MEETING ROOM ON WEDNESDAY 9 MAY 2018 AT 11:00AM**

WELCOME AND MEETING ARRANGEMENTS

Acting Chairperson Cyril Ninnal welcomed all in attendance and declared the meeting open at 12:00noon.

ATTENDANCE AND APOLOGIES

Attendance

Acting Chairperson	Cyril Ninnal
Local Authority Member	Damien Tunmuck
Local Authority Member	Alphonsus Kungul
Local Authority Member	Ken James
Mayor	John Wilson
Elected Member	Wally Minjin
Elected Member	Mark Tunmuck-Smith

Staff:

Chief Executive Officer	Shaun Hardy
Director of Council and Community Services	Steve Horton
Manager Corporate	Rebecca Purser
Civil Services Supervisor	Damian Oppel

Apologies

Nil apologies received

Absent

Local Authority Member	Romelo Tchernia
Local Authority Member	Leon Melpi
Elected Member	Mark Martin

CONFIRMATION OF MINUTES

Minutes of the Wadeye Local Authority Meeting held on 20 February 2018

RECOMMENDATION:

That the minutes be taken as read and be accepted as a true record of the Meeting.

Moved: Ken James

Seconded: Mayor Wilson

Resolution: Unanimously

REPORTS

1) Chief Executive Officer's Report

Chief Executive Officer spoke to his written report.

Further matters to note:

- AMMRIC will be arriving in community 4 to 8 June 2018
- Enterprise Agreement has been approved by Fair Work Commission
- Nurse Advisor for Aged Care has commenced
- 11 August 2018 has been set as the date for the Wadeye Festival
- The switch for the light at the basketball court needs to be located
- Grading on homelands roads has now commenced with the arrival of the dry season
- Softball oval fencing works have been completed.

Motion:

- 1. That the Local Authority notes the report from the Chief Executive Officer.**

Moved: Mayor Wilson

Seconded: Ken James

Resolution: Unanimously

2) Director of Council and Community Services Report

Director of Council and Community Services spoke to his written report.

Matters to note:

- \$356,000 has been committed for homelands projects. Contractors will be commencing works in the near future as all Section 3 works have been signed off by residents.
- Gabrielle Martin is to be contacted for assistance in applying for an ABN for HEA approved works.
- The swimming pool continues to be an issue with regards to vandalism. Discussions are currently underway with various community stakeholders as to an alternative solution for council. A suggestion was that a caretaker be placed onsite in a demountable as a deterrent.
- Civil Services Supervisor is to make inquiries with TDC regarding on the job training for civil staff for graders, bobcats, trucks and other relevant plant and equipment.

Motion:

- 1. That the Local Authority Receives and notes the Director of Council and Community Services Report**

Moved: Cr. Minjin

Seconded: Ken James
Resolution: Unanimously

3) Regional Plan and Budget 2018/2019

Chief Executive Officer spoke to his written report.

Community Services Managers to provide a list of priorities for each community including homelands, in consultation with Local Authority and other community residents.

Motion:

- 1. That the Local Authority notes the information regarding the Regional Plan and Budget 2018/2019.**

Moved: Mayor Wilson
Seconded: Cr. Tunmuck-Smith
Resolution: Unanimously

4) Community Services Manager's Report

Civil Services Supervisor spoke to the Community Services Manager's written report.

Motion:

- 1. That the Local Authority receives and notes the Community Services Manager's Report**

Moved: Cr. Minjin
Seconded: Ken James
Resolution: Unanimously

5) Finance Report

Chief Executive Officer spoke to the Senior Financial Consultant's written report.

CEO highlighted the underspends for Aged Care, Community Night Patrol and Homelands for 2016/2017, if not committed by end of financial year would not be rolled over.

Mayor Wilson requested a workshop for Local Authority Members regarding Guideline 8 and WDRC Policy – Local Authorities with the date for the workshop to be finalised at the next Ordinary Council Meeting.

Motion:

- 1. That the local authority receives and notes financial information provided by Council.**

Moved: Ken James
Seconded: Mayor Wilson
Resolution: Unanimously

6) Local Authority Meeting Dates for 2018/2019 Financial Year

The Local Authority members agreed to the proposed meeting dates however noted that the July date may change due to bush holidays and this change will be discussed closer to the date.

Motion:

1. That the Local Authority notes the dates for the 2018/2019 financial year as follows:

- Tuesday 17 July 2018
- Tuesday 16 October 2018
- Tuesday 12 March 2019
- Tuesday 14 May 2019

Moved: Cr. Tunmuck-Smith

Seconded: Alphonsus Kungul

Resolution: Unanimously

7) Local Authority Members Attendance Records

In accordance with Guideline 8, due to three consecutive absences from Local Authority Meetings, Romelo Tchernia is no longer an appointed member and will be advised in writing.

Motion:

1. That the Local Authority receives and notes the information regarding attendance requirements at Local Authority Meetings and further notes that in accordance with Guideline 8, Romelo Tchernia is no longer an appointed member due to consecutive absences.

Moved: Mayor Wilson

Seconded: Ken James

Resolution: Unanimously

8) Action Items Update

Motion:

- 1. That the Local Authority receives and notes the information regarding the action items update.**
- 2. That the Local Authority recommends to Council that the amount of \$28,992.70 be allocated for the Wadeye Softball Oval Drainage works.**

Moved: Cr. Minjin

Seconded: Ken James

Resolution: Unanimously

9) Walkway/Footbridge - Manthathpe to Wadeye

Motion:

- 1. That the Local Authority recommends to Council that an amount of 50% of the invoice from Nth Degree Engineers be allocated for the Scoping Study for the walkway and elevated footbridge between Manthathpe and Wadeye.**

Moved: Cr. Tunmuck-Smith

Seconded: Mayor Wilson

Resolution: Unanimously

10) Water Bubblers - Main Street and Oval

The quotation provided is for two bubblers only. Further quotations to be sourced for approximately 6 bubblers (two in the main street, two around the oval, one each at both existing playgrounds).

Motion:

- 1. That the Local Authority recommends to Council that an amount of \$50,000 be allocated for the purchase and installation of water bubblers along the main street and around the main oval.**

Moved: Ken James

Seconded: Cr. Tunmuck-Smith

Resolution: Unanimously

11) Playgrounds at Nilinh and Manthathpe

The Local Authority notes the information received however has requested that Council revisit the design of the playgrounds to ensure that they are vandal proof and suitable for remote community.

Motion:

- 1. That the Local Authority notes the information received and requests different design options be presented at the next Local Authority meeting.**

Moved: Cr. Tunmuck-Smith

Seconded: Damien Tunmuck

Resolution: Unanimously

12) Seating around the Oval

Motion:

- 1. That the Local Authority recommends to Council that an amount of \$6,297.50 be allocated for the purchase of 20 aluminium bench**

seats around the main oval with an additional \$1,000 to be allocated for concrete for installation purposes.

Moved: Cr. Minjin
Seconded: Alphonsus Kungul
Resolution: Unanimously

13) Shade Trees

Local authority has requested that the shade trees are not to be Mahogany species.

Motion:

- 1. That the Local Authority recommends to Council that an amount of \$2,475 be allocated for the purchase of shade trees around the main oval and the community.**

Moved: Damien Tunmuck
Seconded: Alphonsus Kungul
Resolution: Unanimously

14) Concrete Speed Humps - Manthathpe

Motion:

- 1. That the Local Authority recommends to Council that an amount of \$50,000 be allocated for the installation of concrete speed humps around Manthathpe, Nilinh, Creek Camp, Bem Street and Banthan Street.**

Moved: Cr. Mark Tunmuck-Smith
Seconded: Mayor Wilson
Resolution: Unanimously

QUESTIONS FROM THE PUBLIC

Nil

NEXT MEETING

Date and time of next meeting: 17 July 2018

MEETING CLOSE

The meeting closed at 2:23pm.

THIS PAGE AND THE PRECEEDING 5 PAGES ARE THE MINUTES OF THE Meeting of
Wadeye Local Authority HELD ON 9 May 2018 AND CONFIRMED _____.



WEST DALY REGIONAL COUNCIL

FOR THE WADEYE LOCAL AUTHORITY OF 17 JULY 2018

Report for Agenda Item No 1

Prepared by **Shaun Hardy, Chief Executive Officer**

Chief Executive Officer's Report

Purpose

The purpose of this report is to update progress on Council activities and inform about issues relevant to the governance and management of Council.

Background

Regional Plan and Budget

Council's Regional Plan and Budget sets out the goals and strategies for what we want to achieve during the financial year. For 2018-19, a draft Regional Plan and Budget has been prepared and public submissions are open until 18 July 2018.

Local priorities were discussed in earlier Local Authority and Council meetings. Program budgets were discussed internally in Council. The Regional Plan and Budget is the subject of a separate Agenda Item.

Community Development

Meetings have been continuing with several stakeholders regarding the Wadeye Festival 2018, which Council and Palngun Wurnagat Aboriginal Corporation are taking the lead on. Wadeye Festival will commence on Friday 10 August with a parade from the School to the Cultural Precinct, and main activities will be held over Saturday and Sunday 11-12 August including a sporting carnival, and NAIDOC Awards on Monday 13 August.

Council is seeking input from both Peppimenarti and Nganmarriyanga Local Authorities and community stakeholders on festival or activities in both communities, which will incorporate NAIDOC celebrations. Council will provide both direct and in-kind support, as it is doing also in Wadeye.

Aged Care

AACQA assessors visited the Thamurrurr Aged Care facility in Wadeye on 15 June 2018 and the findings were positive regarding noticeable improvements including two standards Met and three Part Met. Council is continuing to work through Continuous Improvement Plan actions for both NATSIFACP and

CHSP programs. Interviews for the positions of Manager Aged Care and Nurses have been held and recruitment will be finalised in July 2018. The position of Cook at the Thamurrurr Aged Care facility has also been filled.

Homelands

There has been significant work undertaken over recent months across the Homelands with sourcing quotations and rolling out projects. Roads maintenance grading has also recommenced.

Responses to a tender for four Ablution Blocks at Fossil Head, Old Mission, Delye and Mulingi did not meet Council's requirements as far as specifications and price, but a suitable alternative was sourced for transportable Ablution Block units to be constructed and ready for installation this dry season.

Further discussions are taking place with residents at funded Homelands on their priorities for services and infrastructure, and funding that is available for 2018-19 programs including Homelands Jobs.

Roads

Works on local internal roads damaged during the wet season have been progressing with many potholes and washouts fixed, particularly Wadeye.

Following lengthy delays, Allan King and Sons have mobilised on site and are well underway on the Nganmarriyanga Airport Road Upgrade project. This project is scheduled for completion by end-August 2018, which will be a great outcome for the community improving year-round access.

Discussions have commenced regarding the best approach to seek Government assistance for Council's major road works priorities: Emu Point Access Road; Peppimenarti Access Road; and Woodycupildya Access Road.

West Daly will soon be joining a new Working Group of neighbouring Councils in the Big Rivers region to collaborate and share initiatives around local roads maintenance.

Waste Management

Sims Metal scrap metal collection of car bodies and other hard waste across the West Daly region has commenced with initial collection and transportation of car bodies from Wadeye. This initiative will progress over coming months.

Council has raised the issue of upgrades required for waste management sites at Wadeye (new site required), Nganmarriyanga and Peppimenarti and is seeking assistance from LGANT, who are recruiting a Local Government Environment Project Officer funded by NT EPA, and the Big Rivers Waste Management Working Group.

Animal Management

The first visit to Wadeye by AMRRIC and The Ark veterinarians held from 4- 8 June 2018 was very successful with over 80 animals desexed, and a range of vaccinations and other treatments provided.

Visits to our broader region by University of Melbourne to Nganmarriyanga, Peppimenarti, Emu Point, Woodycupildiya, Merrepen, Namarluk, Wudapuli and Nama were held from 5- 13 July and were also successful.

Staffing

Community Services Managers – Nganmarriyanga and Peppimenarti were finalised with Scott Page and Steve Loring the successful applicants.

The recruitment of a second Mechanic, to be based at Peppimenarti, was also completed with Peter Balasopoulos the successful applicant

Stakeholder Meetings

For the period May to July 2018, I have undertaken external stakeholder meetings as follows:

Australian Aged Care Quality Agency
AG – Health– Aged Care
AG – Prime Minister and Cabinet – Night Patrol
Local Government Professionals Association
Murin Association
National Disability Insurance Scheme
NTG – Chief Minister – Regional Network
NTG – Housing and Community Development
NTG – Trade, Business and Innovation
Palngun Wurnagat Aboriginal Corporation
SeaFarms – Project Sea Dragon
Thamurrurr Development Corporation
West Daly Regional Stakeholders

Impact for Local Authority

For information.

Recommendation

- 1. That the Local Authority note the Chief Executive Officer's report.**

Attachments

There are no attachments for this report.



WEST DALY REGIONAL COUNCIL

FOR THE WADEYE LOCAL AUTHORITY OF 17 JULY 2018

Report for Agenda Item No 2

Prepared by **Shaun Hardy, Chief Executive Officer**

Regional Plan and Budget 2018/2019

Purpose

Council's draft Regional Plan and Budget 2018-19 has been released for public consultation.

Background

Council's Regional Plan and Budget sets out the goals and strategies for what we want to achieve during the financial year including local priorities.

For 2018-19, Council's draft Regional Plan and Budget has been released (see copies tabled at Local Authority meeting or via West Daly website).

Public submissions have been invited via website and newspaper by 18 July 2018, which is 21 days, as required by the *Local Government Act* (Act).

Also required by the Act, Council's Regional Plan and Budget must be formally adopted by Council (which meets on 25 July 2018) and forwarded to the Department of Housing and Community Development by 31 July 2018.

Confirmation of local priorities and final feedback is sought by 18 July 2018.

Impact for Council

For information and feedback.

Recommendation

- 1. That the Local Authority notes Council's draft Regional Plan and Budget 2018-19 and provides final feedback by 18 July 2018.**

Attachments

There are no attachments for this report.



WEST DALY REGIONAL COUNCIL

FOR THE WADEYE LOCAL AUTHORITY OF 17 JULY 2018

Report for Agenda Item No 3

Prepared by **Steve Horton, Director of Council and Community Services**

Director of Council and Community Services's Report

Purpose

To advise Council of the current situation with Homelands, Aged Care and Council Services.

Homelands

A report received from the Department of Housing and Community Development on the annual Homelands assessments for 2017-18 identified works that could or should be done as soon as possible.

Council have been working tirelessly to arrange for works to commence in the outstations and several contractors have been engaged to complete works.

Financial Year 17/18 saw approx. \$1.3m committed to works in the Homelands.

Council staff are now following up on Contractors to ensure that works in the Homelands are progressing. Council staff have been conducting inspections on each of the Outstations to ensure that the works are up to standard and completed as per the agreed quote. Several outstations have had works already undertaken and feed back from residents so far is good.

There have been a few instances where a contractor has not complied with the agreed quote and they have been asked to redo the work as per the agreed quote or they will not have their invoice paid until work is corrected.

At the same time of the inspections, new Homelands Extra Allowance applications for FY 18/19 are being completed and will be submitted to the Department for approval.

Council Staff are also seeking feedback from residents on what they perceive to be the major infrastructure requirement for their Homeland with most saying that the need is as follows:

- Solar Power for all homes
- Road construction, including culverts in problem areas,

- Phone reception, Telstra Booster

This information will be submitted to Head Office for consideration in any proposed ABA applications.

Council has applied for Funding for the Purchase of new equipment such as Tractors, Slashers, Mowers, Mobile Boosters and Water Tanks etc. and if approved items will be purchased and sent to those outstations that requested the equipment, to date we are still waiting to hear back from the Department on the success of these applications

Aged Care

Staffing still is a concern with Local staff not turning up for work. Council has introduced the employee of the month scheme to encourage Local staff to come to work and have introduced Store vouchers as an incentive.

Council has reviewed the staffing structure required to run the Aged Care Facility effectively and have developed a structure that should ensure that WDRC are compliant and meet its obligations under the Funding Agreement.

The revised structure will require additional Nurses and local support staff. Currently council is relying on the support of Agency Staff to operate the Aged Care Facility which is a considerable cost to the Council. Council has recently undertaken a recruitment campaign and have identified so far 4 possible permanent replacements in lieu of the Agency Staff.

Council have also ordered new equipment for Aged Care in all three communities and are waiting on delivery of these items.

Council Services

Road Works have been ongoing and the Civil crew have been active in filling in potholes. Speed humps and additional street lights are to be installed at Manthape and new lights to be installed at the entrance to the Airport.

Council recently employed an additional Mechanic who is based in Peppimenarti but should be available to provide support to Palumpa and Wadeye.

The swimming pool continues to be vandalised by children and this has caused the swimming pool to be out of operation and unfit for use. This has an impact on the council in not being able to meet its contractual obligations with the School who pay for the use of the pool.

Nth Degree engineers recently conducted an inspection of the area designated as the walkway from Manthape to Wadeye and will provide their report back to the Council on proposed construction.

The Library has been relocated to the Council Building and will be available for public use shortly. New shelving for the library books have been purchased and are being installed.

Recommendation

1. **That the Local Authority Receives and notes the Director of Council and Community Services**

Attachments

There are no attachments for this report.



WEST DALY REGIONAL COUNCIL

FOR THE WADEYE LOCAL AUTHORITY OF 17 JULY 2018

Report for Agenda Item No 4

Prepared by **Glenn Parker , Community Services Manager**

Community Services Manager's Report

Public and Street Lighting

2 solar lights are being installed at the airport entrance. The culverts are difficult to see at night and a vehicle recently hit the left-hand side.

Contractor appointed and approved by council to upgrade 70 street lights around Wadeye.

Animal Welfare and Control

Vet programme was well received.
Over 80 animals desexed and a number.
AMRRIC to forward full report to CEO in the near future.

Local Road Maintenance

Ongoing pothole repairs. So far 8 tonne of bitumen has been used which is about half of the holes fixed.

Waste Management And Litter Control

A big effort by the civil crew to clean up street and nature strip rubbish. 2 new quad bikes will arrive in the next week to assist in keeping on top of street rubbish.

Plant And Equipment

Peppi grader has a "knock" in the engine. Mechanic to evaluate and give estimation of repair cost.

Tilt tray truck has had extensive work done to brakes and injectors. Now running very well at long last.

Caterpillar loader has had all hydraulic hoses replaced and is fit for work once again.

Softball Oval

A concentrated effort to have the softball oval and the sports area in general in good shape and green for up coming sporting events and Wadeye Festival.

Further update in "Action Items".

Airport Maintenance

Maintenance good, little or no vandalism for the past few weeks.

Major works taking place repainting the runway and apron area.

The airstrip requires some fencing to be undertaken but is ready for audit inspection on the 17th of July.

Recommendation

- 1. That Local Authority CSM's report with the recommendation of vehicles disposal.**

Attachments

There are no attachments for this report.



WEST DALY REGIONAL COUNCIL
FOR THE WADEYE LOCAL AUTHORITY OF
17 JULY 2018

Report for Agenda Item No 5

Prepared by **Rebecca Purser, Manager Corporate**

Nilinh Stage 2 Subdivision - Department of Infrastructure, Planning and Logistics

Purpose

To seek Local Authority comments and feedback regarding Nilinh Stage 2 Subdivision.

Background

The Department of Infrastructure, Planning and Logistics have provided Council with plans regarding the subdivision for Nilinh.

Council has been asked to provide comment on this project.

Please refer to attached plans for information and discussion.

Impact for Council

Information purposes.

Recommendation

- 1. That the Local Authority notes the information regarding Nilinh Stage 2 Subdivision.**

Attachments

- 1 Nilinh Stage 2 Subdivision**

A map of the 'SITE OF WORKS' area, showing a proposed road route. The map includes labels for various locations: MAQUETTE, PINE CREEK, WATKINS, BORDO DOLE, ALTON, BARKING CREEK, FALST SPRINGS, and FALST. A scale bar indicates distances in miles (0, 1, 2, 3, 4, 5, 6, 7, 8, 9, 10, 11, 12, 13, 14, 15, 16, 17, 18, 19, 20, 21, 22, 23, 24, 25, 26, 27, 28, 29, 30, 31, 32, 33, 34, 35, 36, 37, 38, 39, 40, 41, 42, 43, 44, 45, 46, 47, 48, 49, 50, 51, 52, 53, 54, 55, 56, 57, 58, 59, 60, 61, 62, 63, 64, 65, 66, 67, 68, 69, 70, 71, 72, 73, 74, 75, 76, 77, 78, 79, 80, 81, 82, 83, 84, 85, 86, 87, 88, 89, 90, 91, 92, 93, 94, 95, 96, 97, 98, 99, 100). The map also shows the location of the proposed road and the surrounding areas.



SCHEDULE OF ASSOCIATED DRAWINGS		
DRAWINGS	GENERAL	PROJECT DRAWINGS
		TITLE
43-2271A-0001		TITLE SHEET, LOCALITY PLAN, LOCATION OF WORKS AND CLASSIFICATION OF WORKS
43-2271A-0002		SITE SPECIFICATION PLAN
43-2271A-0003	COIL	GENERAL NOTES AND ABBREVIATIONS
43-2271A-0004		TYPICAL DETAILS
43-2271A-0005		CONCRETE FLOORMAT DETAIL
43-2271A-0006		ROADWAY DETAIL
43-2271A-0007		ROADWAY DETAIL
43-2271A-0008		ROADWAY DETAIL
43-2271A-0009		ROADWAY DETAIL
43-2271A-0010		ROADWAY DETAIL
43-2271A-0011		ROADWAY DETAIL
43-2271A-0012		ROADWAY DETAIL
43-2271A-0013		ROADWAY DETAIL
43-2271A-0014		ROADWAY DETAIL
43-2271A-0015		ROADWAY DETAIL
43-2271A-0016		ROADWAY DETAIL
43-2271A-0017		ROADWAY DETAIL
43-2271A-0018		ROADWAY DETAIL
43-2271A-0019		ROADWAY DETAIL
43-2271A-0020		ROADWAY DETAIL
43-2271A-0021		ROADWAY DETAIL
43-2271A-0022		ROADWAY DETAIL
43-2271A-0023		ROADWAY DETAIL
43-2271A-0024		ROADWAY DETAIL
43-2271A-0025		ROADWAY DETAIL
43-2271A-0026		ROADWAY DETAIL
43-2271A-0027		ROADWAY DETAIL
43-2271A-0028		ROADWAY DETAIL
43-2271A-0029		ROADWAY DETAIL
43-2271A-0030		ROADWAY DETAIL
43-2271A-0031		ROADWAY DETAIL
43-2271A-0032		ROADWAY DETAIL
43-2271A-0033		ROADWAY DETAIL
43-2271A-0034		ROADWAY DETAIL
43-2271A-0035		ROADWAY DETAIL
43-2271A-0036		ROADWAY DETAIL
43-2271A-0037		ROADWAY DETAIL
43-2271A-0038		ROADWAY DETAIL
43-2271A-0039		ROADWAY DETAIL
43-2271A-0040		ROADWAY DETAIL
43-2271A-0041		ROADWAY DETAIL
43-2271A-0042		ROADWAY DETAIL
43-2271A-0043		ROADWAY DETAIL
43-2271A-0044		ROADWAY DETAIL
43-2271A-0045		ROADWAY DETAIL
43-2271A-0046		ROADWAY DETAIL
43-2271A-0047		ROADWAY DETAIL
43-2271A-0048		ROADWAY DETAIL
43-2271A-0049		ROADWAY DETAIL
43-2271A-0050		ROADWAY DETAIL
43-2271A-0051		ROADWAY DETAIL
43-2271A-0052		ROADWAY DETAIL
43-2271A-0053		ROADWAY DETAIL
43-2271A-0054		ROADWAY DETAIL
43-2271A-0055		ROADWAY DETAIL
43-2271A-0056		ROADWAY DETAIL
43-2271A-0057		ROADWAY DETAIL
43-2271A-0058		ROADWAY DETAIL
43-2271A-0059		ROADWAY DETAIL
43-2271A-0060		ROADWAY DETAIL
43-2271A-0061		ROADWAY DETAIL
43-2271A-0062		ROADWAY DETAIL
43-2271A-0063		ROADWAY DETAIL
43-2271A-0064		ROADWAY DETAIL
43-2271A-0065		ROADWAY DETAIL
43-2271A-0066		ROADWAY DETAIL
43-2271A-0067		ROADWAY DETAIL
43-2271A-0068		ROADWAY DETAIL
43-2271A-0069		ROADWAY DETAIL
43-2271A-0070		ROADWAY DETAIL
43-2271A-0071		ROADWAY DETAIL
43-2271A-0072		ROADWAY DETAIL
43-2271A-0073		ROADWAY DETAIL
43-2271A-0074		ROADWAY DETAIL
43-2271A-0075		ROADWAY DETAIL
43-2271A-0076		ROADWAY DETAIL
43-2271A-0077		ROADWAY DETAIL
43-2271A-0078		ROADWAY DETAIL
43-2271A-0079		ROADWAY DETAIL
43-2271A-0080		ROADWAY DETAIL
43-2271A-0081		ROADWAY DETAIL
43-2271A-0082		ROADWAY DETAIL
43-2271A-0083		ROADWAY DETAIL
43-2271A-0084		ROADWAY DETAIL
43-2271A-0085		ROADWAY DETAIL
43-2271A-0086		ROADWAY DETAIL
43-2271A-0087		ROADWAY DETAIL
43-2271A-0088		ROADWAY DETAIL
43-2271A-0089		ROADWAY DETAIL
43-2271A-0090		ROADWAY DETAIL
43-2271A-0091		ROADWAY DETAIL
43-2271A-0092		ROADWAY DETAIL
43-2271A-0093		ROADWAY DETAIL
43-2271A-0094		ROADWAY DETAIL
43-2271A-0095		ROADWAY DETAIL
43-2271A-0096		ROADWAY DETAIL
43-2271A-0097		ROADWAY DETAIL

[illegible]

PWC STANDARD DRAWINGS (ELECTRICAL)		REV.	DATE	DESCRIPTION
50A1-1-149	POLES 100 & 150' - 25' TO 100' TYPE 1			
50A1-1-150	POLES 100 & 150' - 25' TO 100' TYPE 2			
50A1-1-151	POLES 100 & 150' - 25' TO 100' TYPE 3			
50A1-1-152	POLES 100 & 150' - 25' TO 100' TYPE 4			
50A1-1-153	POLES 100 & 150' - 25' TO 100' TYPE 5			
50A1-1-154	POLES 100 & 150' - 25' TO 100' TYPE 6			
50A1-1-155	POLES 100 & 150' - 25' TO 100' TYPE 7			
50A1-1-156	POLES 100 & 150' - 25' TO 100' TYPE 8			
50A1-1-157	POLES 100 & 150' - 25' TO 100' TYPE 9			
50A1-1-158	POLES 100 & 150' - 25' TO 100' TYPE 10			
50A1-1-159	POLES 100 & 150' - 25' TO 100' TYPE 11			
50A1-1-160	POLES 100 & 150' - 25' TO 100' TYPE 12			
50A1-1-161	POLES 100 & 150' - 25' TO 100' TYPE 13			
50A1-1-162	POLES 100 & 150' - 25' TO 100' TYPE 14			
50A1-1-163	POLES 100 & 150' - 25' TO 100' TYPE 15			
50A1-1-164	POLES 100 & 150' - 25' TO 100' TYPE 16			
50A1-1-165	POLES 100 & 150' - 25' TO 100' TYPE 17			
50A1-1-166	POLES 100 & 150' - 25' TO 100' TYPE 18			
50A1-1-167	POLES 100 & 150' - 25' TO 100' TYPE 19			
50A1-1-168	POLES 100 & 150' - 25' TO 100' TYPE 20			
50A1-1-169	POLES 100 & 150' - 25' TO 100' TYPE 21			
50A1-1-170	POLES 100 & 150' - 25' TO 100' TYPE 22			
50A1-1-171	POLES 100 & 150' - 25' TO 100' TYPE 23			
50A1-1-172	POLES 100 & 150' - 25' TO 100' TYPE 24			
50A1-1-173	POLES 100 & 150' - 25' TO 100' TYPE 25			
50A1-1-174	POLES 100 & 150' - 25' TO 100' TYPE 26			
50A1-1-175	POLES 100 & 150' - 25' TO 100' TYPE 27			
50A1-1-176	POLES 100 & 150' - 25' TO 100' TYPE 28			
50A1-1-177	POLES 100 & 150' - 25' TO 100' TYPE 29			
50A1-1-178	POLES 100 & 150' - 25' TO 100' TYPE 30			
50A1-1-179	POLES 100 & 150' - 25' TO 100' TYPE 31			
50A1-1-180	POLES 100 & 150' - 25' TO 100' TYPE 32			
50A1-1-181	POLES 100 & 150' - 25' TO 100' TYPE 33			
50A1-1-182	POLES 100 & 150' - 25' TO 100' TYPE 34			
50A1-1-183	POLES 100 & 150' - 25' TO 100' TYPE 35			
50A1-1-184	POLES 100 & 150' - 25' TO 100' TYPE 36			
50A1-1-185	POLES 100 & 150' - 25' TO 100' TYPE 37			
50A1-1-186	POLES 100 & 150' - 25' TO 100' TYPE 38			
50A1-1-187	POLES 100 & 150' - 25' TO 100' TYPE 39			
50A1-1-188	POLES 100 & 150' - 25' TO 100' TYPE 40			
50A1-1-189	POLES 100 & 150' - 25' TO 100' TYPE 41			
50A1-1-190	POLES 100 & 150' - 25' TO 100' TYPE 42			
50A1-1-191	POLES 100 & 150' - 25' TO 100' TYPE 43			
50A1-1-192	POLES 100 & 150' - 25' TO 100' TYPE 44			
50A1-1-193	POLES 100 & 150' - 25' TO 100' TYPE 45			
50A1-1-194	POLES 100 & 150' - 25' TO 100' TYPE 46			
50A1-1-195	POLES 100 & 150' - 25' TO 100' TYPE 47			
50A1-1-196	POLES 100 & 150' - 25' TO 100' TYPE 48			
50A1-1-197	POLES 100 & 150' - 25' TO 100' TYPE 49			
50A1-1-198	POLES 100 & 150' - 25' TO 100' TYPE 50			
50A1-1-199	POLES 100 & 150' - 25' TO 100' TYPE 51			
50A1-1-200	POLES 100 & 150' - 25' TO 100' TYPE 52			
50A1-1-201	POLES 100 & 150' - 25' TO 100' TYPE 53			
50A1-1-202	POLES 100 & 150' - 25' TO 100' TYPE 54			
50A1-1-203	POLES 100 & 150' - 25' TO 100' TYPE 55			
50A1-1-204	POLES 100 & 150' - 25' TO 100' TYPE 56			
50A1-1-205	POLES 100 & 150' - 25' TO 100' TYPE 57			
50A1-1-206	POLES 100 & 150' - 25' TO 100' TYPE 58			
50A1-1-207	POLES 100 & 150' - 25' TO 100' TYPE 59			
50A1-1-208	POLES 100 & 150' - 25' TO 100' TYPE 60			
50A1-1-209	POLES 100 & 150' - 25' TO 100' TYPE 61			
50A1-1-210	POLES 100 & 150' - 25' TO 100' TYPE 62			
50A1-1-211	POLES 100 & 150' - 25' TO 100' TYPE 63			
50A1-1-212	POLES 100 & 150' - 25' TO 100' TYPE 64			
50A1-1-213	POLES 100 & 150' - 25' TO 100' TYPE 65			
50A1-1-214	POLES 100 & 150' - 25' TO 100' TYPE 66			
50A1-1-215	POLES 100 & 150' - 25' TO 100' TYPE 67			
50A1-1-216	POLES 100 & 150' - 25' TO 100' TYPE 68			
50A1-1-217	POLES 100 & 150' - 25' TO 100' TYPE 69			
50A1-1-218	POLES 100 & 150' - 25' TO 100' TYPE 70			
50A1-1-219	POLES 100 & 150' - 25' TO 100' TYPE 71			
50A1-1-220	POLES 100 & 150' - 25' TO 100' TYPE 72			
50A1-1-221	POLES 100 & 150' - 25' TO 100' TYPE 73			
50A1-1-222	POLES 100 & 150' - 25' TO 100' TYPE 74			
50A1-1-223	POLES 100 & 150' - 25' TO 100' TYPE 75			
50A1-1-224	POLES 100 & 150' - 25' TO 100' TYPE 76			
50A1-1-225	POLES 100 & 150' - 25' TO 100' TYPE 77			
50A1-1-226	POLES 100 & 150' - 25' TO 100' TYPE 78			
50A1-1-227	POLES 100 & 150' - 25' TO 100' TYPE 79			
50A1-1-228	POLES 100 & 150' - 25' TO 100' TYPE 80			
50A1-1-229	POLES 100 & 150' - 25' TO 100' TYPE 81			
50A1-1-230	POLES 100 & 150' - 25' TO 100' TYPE 82			
50A1-1-231	POLES 100 & 150' - 25' TO 100' TYPE 83			
50A1-1-232	POLES 100 & 150' - 25' TO 100' TYPE 84			
50A1-1-233	POLES 100 & 150' - 25' TO 100' TYPE 85			
50A1-1-234	POLES 100 & 150' - 25' TO 100' TYPE 86			
50A1-1-235	POLES 100 & 150' - 25' TO 100' TYPE 87			
50A1-1-236	POLES 100 & 150' - 25' TO 100' TYPE 88			
50A1-1-237	POLES 100 & 150' - 25' TO 100' TYPE 89			
50A1-1-238	POLES 100 & 150' - 25' TO 100' TYPE 90			
50A1-1-239	POLES 100 & 150' - 25' TO 100' TYPE 91			
50A1-1-240	POLES 100 & 150' - 25' TO 100' TYPE 92			
50A1-1-241	POLES 100 & 150' - 25' TO 100' TYPE 93			
50A1-1-242	POLES 100 & 150' - 25' TO 100' TYPE 94			
50A1-1-243	POLES 100 & 150' - 25' TO 100' TYPE 95			
50A1-1-244	POLES 100 & 150' - 25' TO 100' TYPE 96			
50A1-1-245	POLES 100 & 150' - 25' TO 100' TYPE 97			
50A1-1-246	POLES 100 & 150' - 25' TO 100' TYPE 98			
50A1-1-247	POLES 100 & 150' - 25' TO 100' TYPE 99			
50A1-1-248	POLES 100 & 150' - 25' TO 100' TYPE 100			
50A1-1-249	POLES 100 & 150' - 25' TO 100' TYPE 101			
50A1-1-250	POLES 100 & 150' - 25' TO 100' TYPE 102			
50A1-1-251	POLES 100 & 150' - 25' TO 100' TYPE 103			
50A1-1-252	POLES 100 & 150' - 25' TO 100' TYPE 104			
50A1-1-253	POLES 100 & 150' - 25' TO 100' TYPE 105			
50A1-1-254	POLES 100 & 150' - 25' TO 100' TYPE 106			
50A1-1-255	POLES 100 & 150' - 25' TO 100' TYPE 107			
50A1-1-256	POLES 100 & 150' - 25' TO 100' TYPE 108			
50A1-1-257	POLES 100 & 150' - 25' TO 100' TYPE 109			
50A1-1-258	POLES 100 & 150' - 25' TO 100' TYPE 110			
50A1-1-259	POLES 100 & 150' - 25' TO 100' TYPE 111			
50A1-1-260	POLES 100 & 150' - 25' TO 100' TYPE 112			
50A1-1-261	POLES 100 & 150' - 25' TO 100' TYPE 113			
50A1-1-262	POLES 100 & 150' - 25' TO 100' TYPE 114			
50A1-1-263	POLES 100 & 150' - 25' TO 100' TYPE 115			
50A1-1-264	POLES 100 & 150' - 25' TO 100' TYPE 116			
50A1-1-265	POLES 100 & 150' - 25' TO 100' TYPE 117			
50A1-1-266	POLES 100 & 150' - 25' TO 100' TYPE 118			
50A1-1-267	POLES 100 & 150' - 25' TO 100' TYPE 119			
50A1-1-268	POLES 100 & 150' - 25' TO 100' TYPE 120			
50A1-1-269	POLES 100 & 150' - 25' TO 100' TYPE 121			
50A1-1-270	POLES 100 & 150' - 25' TO 100' TYPE 122			
50A1-1-271	POLES 100 & 150' - 25' TO 100' TYPE 123			
50A1-1-272	POLES 100 & 150' - 25' TO 100' TYPE 124			
50A1-1-273	POLES 100 & 150' - 25' TO 100' TYPE 125			
50A1-1-274	POLES 100 & 150' - 25' TO 100' TYPE 126			
50A1-1-275	POLES 100 & 150' - 25' TO 100' TYPE 127			
50A1-1-276	POLES 100 & 150' - 25' TO 100' TYPE 128			
50A1-1-277	POLES 100 & 150' - 25' TO 100' TYPE 129			
50A1-1-278	POLES 100 & 150' - 25' TO 100' TYPE 130			
50A1-1-279	POLES 100 & 150' - 25' TO 100' TYPE 131			
50A1-1-280	POLES 100 & 150' - 25' TO 100' TYPE 132			
50A1-1-281	POLES 100 & 150' - 25' TO 100' TYPE 133			
50A1-1-282	POLES 100 & 150' - 25' TO 100' TYPE 134			
50A1-1-283	POLES 100 & 150' - 25' TO 100' TYPE 135			
50A1-1-284	POLES 100 & 150' - 25' TO 100' TYPE 136			
50A1-1-285	POLES 100 & 150' - 25' TO 100' TYPE 137			
50A1-1-286	POLES 100 & 150' - 25' TO 100' TYPE 138			
50A1-1-287	POLES 100 & 150' - 25' TO 100' TYPE 139			
50A1-1-288	POLES 100 & 150' - 25' TO 100' TYPE 140			
50A1-1-289	POLES 100 & 150' - 25' TO 100' TYPE 141			
50A1-1-290	POLES 100 & 150' - 25' TO 100' TYPE 142			
50A1-1-291	POLES 100 & 150' - 25' TO 100' TYPE 143			
50A1-1-292	POLES 100 & 150' - 25' TO 100' TYPE 144			
50A1-1-293	POLES 100 & 150' - 25' TO 100' TYPE 145			
50A1-1-294	POLES 100 & 150' - 25' TO 100' TYPE 146			
50A1-1-295	POLES 100 & 150' - 25' TO 100' TYPE 147			
50A1-1-296	POLES 100 & 150' - 25' TO 100' TYPE 148			
50A1-1-297	POLES 100 & 150' - 25' TO 100' TYPE 149			
50A1-1-298	POLES 100 & 150' - 25' TO 100' TYPE 150			
50A1-1-299	POLES 100 & 150' - 25' TO 100' TYPE 151			
50A1-1-300	POLES 100 & 150' - 25' TO 100' TYPE 152			
50A1-1-301	POLES 100 & 150' - 25' TO 100' TYPE 153			
50A1-1-302	POLES 100 & 150' - 25' TO 100' TYPE 154			
50A1-1-303	POLES 100 & 150' - 25' TO 100' TYPE 155			
50A1-1-304	POLES 100 & 150' - 25' TO 100' TYPE 156			
50A1-1-305	POLES 100 & 150' - 25' TO 100' TYPE 157			
50A1-1-306	POLES 100 & 150' - 25' TO 100' TYPE 158			
50A1-1-307	POLES 100 & 150' - 25' TO 100' TYPE 159			
50A1-1-308	POLES 100 & 150' - 25' TO 100' TYPE 160			
50A1-1-309	POLES 100 & 150' - 25' TO 100' TYPE 161			
50A1-1-310	POLES 100 & 150' - 25' TO 100' TYPE 162			
50A1-1-311	POLES 100 & 150' - 25' TO 100' TYPE 163			
50A1-1-312	POLES 100 & 150' - 25' TO 100' TYPE 164			
50A1-1-313	POLES 100 & 150' - 25' TO 100' TYPE 165			
50A1-1-314	POLES 100 & 150' - 25' TO 100' TYPE 166			
50A1-1-315	POLES 100 & 150' - 25' TO 100' TYPE 167			
50A1-1-316	POLES 100 & 150' - 25' TO 100' TYPE 168			
50A1-1-317	POLES 100 & 150' - 25' TO 100' TYPE 169			
50A1-1-318	POLES 100 & 150' - 25' TO 100' TYPE 170			
50A1-1-319	POLES 100 & 150' - 25' TO 100' TYPE 171			
50A1-1-320	POLES 100 & 150' - 25' TO 100' TYPE 172			
50A1-1-321	POLES 100 & 150' - 25' TO 100' TYPE 173			
50A1-1-322	POLES 100 & 150' - 25' TO 100' TYPE 174			
50A1-1-323	POLES 100 & 150' - 25' TO 100' TYPE 175			
50A1-1-324	POLES 100 & 150' - 25' TO 100' TYPE 176			
50A1-1-325	POLES 100 & 150' - 25' TO 100' TYPE 177			
50A1-1-326	POLES 100 & 150' - 25' TO 100' TYPE 178			
50A1-1-327	POLES 100 & 150' - 25' TO 100' TYPE 179			
50A1-1-328	POLES 100 & 150' - 25' TO 100' TYPE 180			
50A1-1-329	POLES 100 & 150' - 25' TO 100' TYPE 181			
50A1-1-330	POLES 100 & 150' - 25' TO 100' TYPE 182			
50A1-1-331	POLES 100 & 150' - 25' TO 100' TYPE 183			
50A1-1-332	POLES 100 & 150' - 25' TO 100' TYPE 184			
50A1-1-333	POLES 100 & 150' - 25' TO 100' TYPE 185			
50A1-1-334	POLES 100 & 150' - 25' TO 100' TYPE 186			
50A1-1-335	POLES 100 & 150' - 25' TO 100' TYPE 187			
50A1-1-336	POLES 100 & 150' - 25' TO 100' TYPE 188			
50A1-1-337	POLES 100 & 150' - 25' TO 10			

STANDARD DRAWINGS	
LC - ROADWORKS	
DRAWINGS	DRAWING TITLE
LC 100-10	ROADWAY INTERSECTION T-200
REV	

LOCATION OF WORKS

PRELIMINARY

TABLE 2					
Item	DESCRIPTION	DATE	BY	DATE	BY
1	MAILED FOR NEW REVIEW	11-06-79	WBB	0-0-0	
2	MAILED FOR NEW REVIEW	10-14-79	WBB	0-0-0	

TRAD	DECIDED	J. NOTHAY DATE FEB 2016
CE	DECIDED	B. JONES DATE FEB 2016
Y	NOT PRODUCT RELEASED	C. FERRERA

**Northern Territory
Government**

DEVELOPMENT
PHASE 2 SUBDIVISION DESIGN
TITLE SHEET, LOCALITY PLAN
AND SCHEDULE OF DRAWINGS

LOCATION OF WORKS.

PO Box 2611 Durham, NC 27602
(610) 422-2700 FAX (610) 422-1025
Internet: <http://www.durham.edu>

© 2001 IBM Corp. All rights reserved. IBM, the IBM logo, and the e-business logo are trademarks of International Business Machines Corporation. All other trademarks are the property of their respective owners.

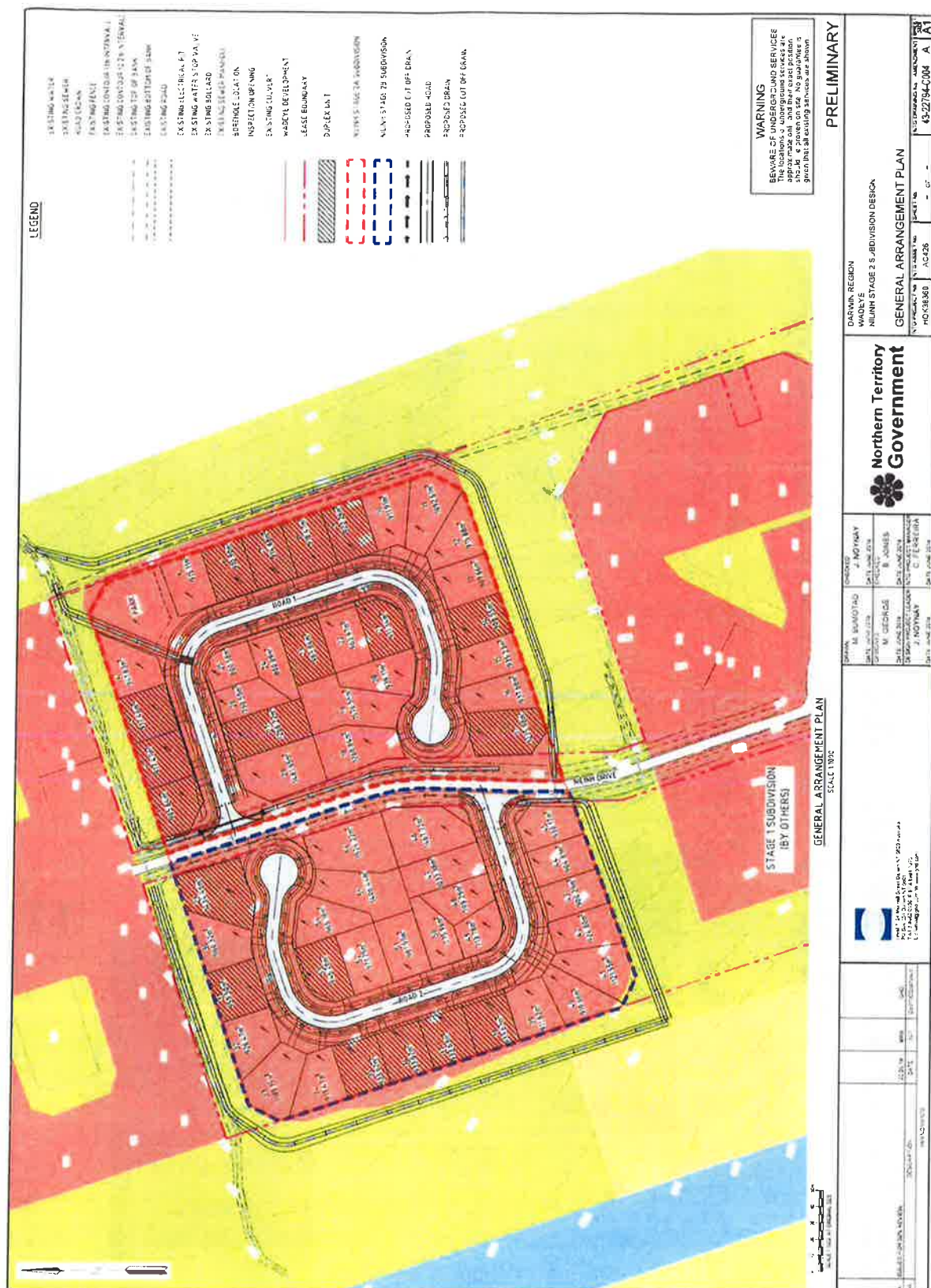

[illegible]

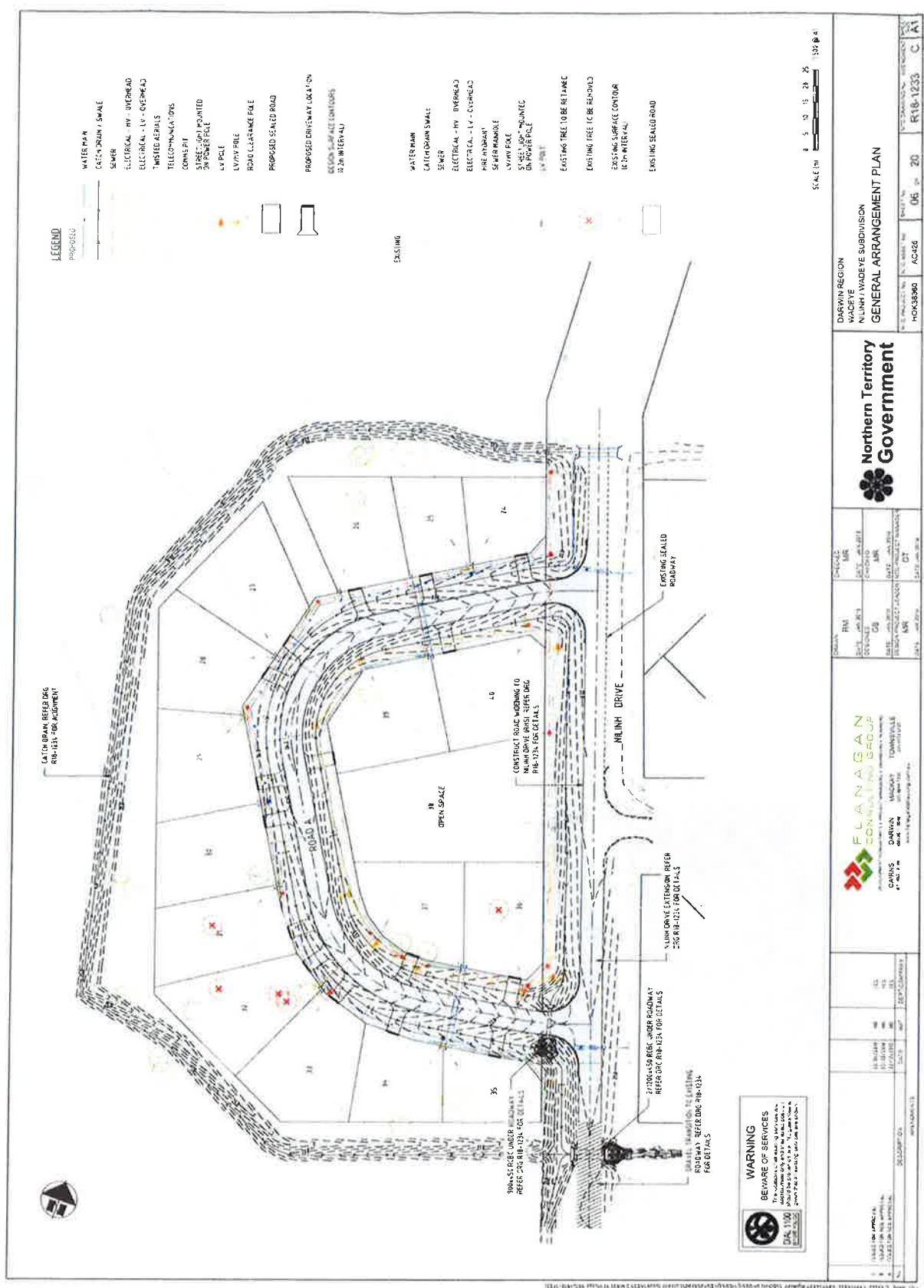

WEST DALY REGIONAL COUNCIL

FOR THE WADEYE LOCAL AUTHORITY OF 17 JULY 2018

Report for Agenda Item No 6

Prepared by Ramesh Pudasaini, Senior Financial Consultant

Finance Report

Purpose

Provide Financial Information (4th Quarter) to Local Authority.

Background

As per Guideline 8, council must provide quarterly financial information to local authority member.

Details of Local Authority Fund;

Natural Account	Actual	Commitments	Total Actual	Annual Budget	Funds Available
37410 - WIP Plant & Equ	32,970	0	32,970	0	(32,970)
62100 - NTG - Opera Gr	(385,370)	0	(385,370)	(385,372)	(2)
68940 - G Income Op b/f	(330,801)	0	(330,801)	(330,801)	
71601 - Outsourced Serv	600	0	600	0	(600)
73330 - Catering	782	0	782	0	(782)
73332 - Consumable Item	29	0	29	0	(29)
73511 - Freight Expense	501	0	501	0	(501)
73800 - Contractor M&L	203,142	0	203,142	716,172	513,030
73834 - R & M Roads	1,724	0	1,724	0	(1,724)
	(476,423)	0	(476,423)	(1)	476,422

Impact for Council

Compliance with Guideline 8 rules and regulation.

Recommendation

1. That the local authority receives and notes financial information provided by Council.

Attachments

- 1 Program Expenses Report - 700.pdf
- 2 Budget Management Report - 700.pdf

Statement of Financial Performance (Expenses Only)

For periods 10 11 12
 Local Authority Region / Office: Wadeye
 YTD Period from 1st July (inc Prd 0) 2017 to 30th June 2018

Council Funds	Actual Amount	Quarter 4 Budget Amount	Variance \$	Actual Amount	YTD Budget Amount	Variance \$	Comments	Amount Remaining to Balance Budget for the Year	Forecast	Annual Budget
AD Administration	563,046	514,659	48,386	2,203,944	2,095,606	108,338	0	1,005,278	2,203,944	2,095,606
AF Asset Management	178,641	160,446	18,195	491,957	641,796	(149,839)	0	149,935	491,957	641,796
CA Commercial Arm	72,055	10,445	61,610	87,300	43,696	43,604	0	143,696	87,300	43,696
CE Chief Executive	70,746	66,465	4,281	271,787	284,234	(12,447)	0	12,447	271,787	284,234
CI Council Service	140,030	148,565	(8,535)	491,506	648,114	(156,608)	0	156,608	491,506	648,114
EM Elected Members	34,572	87,237	(52,664)	133,404	348,948	(215,544)	0	215,544	133,404	348,948
HS Housing - Staff	101,367	263,306	(161,939)	88,933	448,174	(359,241)	0	359,241	88,933	448,174
PG Parks and Garde	35,602	11,445	24,157	148,670	119,826	28,844	614	128,526	148,670	119,826
PL Pests	42,432	28,590	13,842	75,467	182,551	(107,084)	0	107,084	75,467	182,551
RM Road Maintenance	30,773	46,548	(15,775)	24,618	124,880	(100,262)	0	100,262	24,618	124,880
SG Special Purpose	12,687	3,120	9,567	15,501	12,480	3,021	0	13,021	15,501	12,480
TR Training & Devel	4,546	2,495	2,051	27,396	9,896	17,500	0	117,400	27,396	9,896
WM Waste Management	1,461	1,251	210	10,466	5,004	5,462	0	15,462	10,466	5,004
WVS Work Health and							614	730,783	4,274,786	5,015,185
Council Funds sub-total	1,306,727	1,375,052	(68,325)	4,274,786	5,015,185	(740,397)		730,783		
Agency Funds										
AG Aged Care Serv	944,318	657,373	286,945	2,243,282	2,739,014	(495,732)	0	494,732	2,243,282	2,739,014
CP Community Part	235,576	180,960	154,616	647,606	804,544	(156,938)	0	156,938	647,606	804,544
ES Essential Serv	0	28,506	(28,506)	0	123,442	(123,442)	0	123,442	0	123,442
LA Local Authori	150,219	180,050	(29,831)	209,812	720,360	(510,548)	0	510,548	209,812	720,360
U Libraries	12,050	31,857	(19,807)	103,780	133,428	(29,648)	0	29,648	103,780	133,428
OC Outlets and	259,908	140,037	119,871	89,806	572,148	(482,342)	0	482,342	89,806	572,148
SR Sport and Rec	3,040	16,407	(13,367)	89,806	85,628	4,178	0	4,178	89,806	85,628
VC Vacation Care	8,967	25,000	(16,033)	8,967	100,000	(91,033)	0	91,033	8,967	100,000
Agency Funds sub-total	1,614,080	1,273,752	340,327	3,614,631	5,257,572	(1,642,941)	0	1,642,941	3,614,631	5,257,572
Internal Funds										
AD Administration	(161,003)	(100,272)	(60,731)	(688,626)	(401,083)	(11,162)	0	(11,162)	(688,626)	(401,083)
AF Asset Management	(208,230)	(197,280)	(10,950)	(771,659)	(668,000)	(42,659)	0	(42,659)	(771,659)	(668,000)
AG Aged Care Serv	37,464	60,000	(22,536)	87,582	240,000	(152,418)	0	(152,418)	87,582	240,000
CA Commercial Arm	0	0	0	22,127	0	22,127	0	0	22,127	0
CE Chief Executive	16,234	12,300	3,934	22,396	48,200	(25,804)	0	(25,804)	22,396	48,200
CI Council Service	52,946	0	52,946	211,776	0	211,776	0	(211,776)	211,776	0
CP Community Part	24,576	0	24,576	106,815	0	106,815	0	(106,815)	106,815	0
EM Elected Members	0	7,500	(7,500)	0	30,000	(30,000)	0	30,000	0	30,000
HS Housing - Staff	(85,421)	(103,470)	18,049	(341,664)	(413,880)	72,216	0	(72,216)	(341,664)	(413,880)
PG Parks and Garde	0	11,250	(11,250)	0	45,000	(45,000)	0	(45,000)	0	45,000
PL Pests	1,500	0	1,500	2,500	0	2,500	0	2,500	2,500	0
RM Road Maintenance	0	15,000	(15,000)	0	60,000	(60,000)	0	(60,000)	0	60,000
SG Special Purpose	5,881	0	5,881	23,532	0	23,532	0	(23,532)	23,532	0
SR Sport and Rec	0	0	0	3,500	0	3,500	0	3,500	3,500	0

C:\Users\pudman1\AppData\Local\Temp\XOneTemp6\Report_XL1_LA_PROGSAVS_EXPONLY_V3%40191214

	Quarter 4				YTD				Amount Remaining to Balance Budget for the Year	Forecast	Annual Budget
	Actual Amount	Budget Amount	Variance		Actual Amount	Budget Amount	Variance				
			\$				\$				
WMA											
Waste Management	44,022	27,501	16,521		176,086	110,004	66,084	0	66,084	176,086	110,004
Internal funds sub-total	(273,442)	(237,443)	(36,001)		(736,453)	(646,764)	213,311	0	(213,311)	(736,453)	(646,764)
Total before depreciation	2,646,374	2,411,363	235,011		7,152,966	9,322,893	(2,170,027)	614	2,168,413	7,152,966	9,322,893
Depreciation											
AF											
Asset Management	484,046	586,797	(102,751)		1,911,640	2,347,188	(435,548)	0	435,548	1,911,640	2,347,188
Depreciation sub-total	484,046	586,797	(102,751)		1,911,640	2,347,188	(435,548)	0	435,548	1,911,640	2,347,188
Grand Total	3,130,420	2,998,160	132,260		9,064,606	11,670,181	(2,605,575)	614	2,604,064	9,064,606	11,670,181



Ledger: 3862AC and 3862BD

From period: 1 to period: 12

Budget Management Report Local Authority Region/ Office : Wadeye

Expenses

Local Authority Region & Program	Program Code	Income (excluding internal income)	Internal Income	Total Income	Budgeted Income (including internal income)	Income Variance	Administration, Audit and Legal Expenses	Employee, External Members & Consultant Expenses	Operating Expenses	Region & Maintenance	Other	Expenditure Total (including internal expenditure)	Internal Expenditure	Total Expenditure	Budgeted Expenditure (including internal charges)	Expenditure Variance	Program Expense Position
Region: Wadeye																	
01 - Administration	01	1,500,000	0	1,500,000	1,500,000	-200,000	11,800	1,181,100	200,000	20,000	0	2,001,900	1,500,000	3,501,900	3,500,000	1,901,900	Over Budget
02 - Asset Management	02	0	0	0	0	0	0	0	0	0	0	0	0	0	0	0	On Budget
03 - Audit Management	03	0	0	0	0	0	0	0	0	0	0	0	0	0	0	0	On Budget
04 - Capital Expenditure	04	0	0	0	0	0	0	0	0	0	0	0	0	0	0	0	On Budget
05 - Community Services	05	0	0	0	0	0	0	0	0	0	0	0	0	0	0	0	On Budget
06 - Corporate Services	06	0	0	0	0	0	0	0	0	0	0	0	0	0	0	0	On Budget
07 - Cultural Services	07	0	0	0	0	0	0	0	0	0	0	0	0	0	0	0	On Budget
08 - Economic Development	08	0	0	0	0	0	0	0	0	0	0	0	0	0	0	0	On Budget
09 - Environmental Management	09	0	0	0	0	0	0	0	0	0	0	0	0	0	0	0	On Budget
10 - General Administration	10	0	0	0	0	0	0	0	0	0	0	0	0	0	0	0	On Budget
11 - General Services	11	0	0	0	0	0	0	0	0	0	0	0	0	0	0	0	On Budget
12 - Health Services	12	0	0	0	0	0	0	0	0	0	0	0	0	0	0	0	On Budget
13 - Information Services	13	0	0	0	0	0	0	0	0	0	0	0	0	0	0	0	On Budget
14 - Local Authorities and Superfunds	14	0	0	0	0	0	0	0	0	0	0	0	0	0	0	0	On Budget
Total		1,500,000	0	1,500,000	1,500,000	-200,000	11,800	1,181,100	200,000	20,000	0	2,001,900	1,500,000	3,501,900	3,500,000	1,901,900	

Region: Wadeye (Expenses by Category)

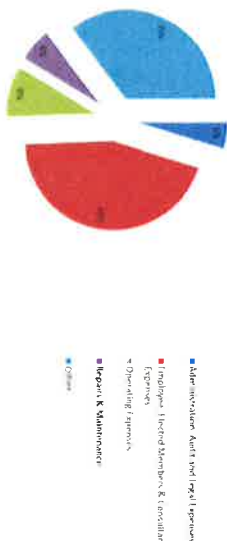

Region: Wadeye (Expenses)

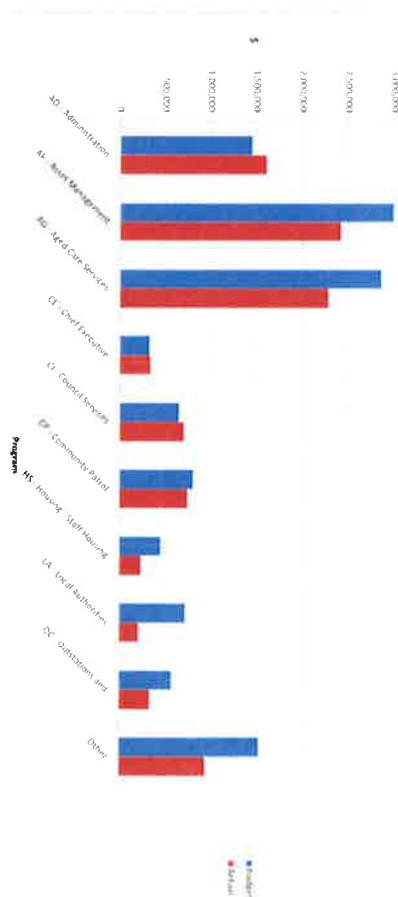

Top 5 Expenses Variance (Over/Under)

Local Authority Region & Program	Program Code	Administration	Audit and Legal	Employee, External Members & Consultant	Operating Expenses	Region & Maintenance	Other	Expenditure Total (including internal expenditure)	Internal Expenditure	Total Expenditure	Budgeted Expenditure	Expense Variance
Region: Wadeye		11,800	0	1,181,100	200,000	20,000	0	2,001,900	1,500,000	3,501,900	3,500,000	1,901,900

	1	2	3	4	5	6	7	8	9	10	11	12	13	14	15	16	17	18	19	20	21	22	23	24	25	26	27	28	29	30	31	32	33	34	35	36	37	38	39	40	41	42	43	44	45	46	47	48	49	50	51	52	53	54	55	56	57	58	59	60	61	62	63	64	65	66	67	68	69	70	71	72	73	74	75	76	77	78	79	80	81	82	83	84	85	86	87	88	89	90	91	92	93	94	95	96	97	98	99	100
1	2	3	4	5	6	7	8	9	10	11	12	13	14	15	16	17	18	19	20	21	22	23	24	25	26	27	28	29	30	31	32	33	34	35	36	37	38	39	40	41	42	43	44	45	46	47	48	49	50	51	52	53	54	55	56	57	58	59	60	61	62	63	64	65	66	67	68	69	70	71	72	73	74	75	76	77	78	79	80	81	82	83	84	85	86	87	88	89	90	91	92	93	94	95	96	97	98	99	100	

[illegible]

Region/Province	Local Authority/Region & Program Code	Administrative, Policy and Policy Expenses	Community Grants	Depreciation	Employee Expense & Pension & Social Security	Operating Expenses	Region & Miscellaneous	Other	Expenditure Total (before regional expenditure)	Internal Revenue	Total Revenue	Adjusted Expenditure	Excess/Shortfall
AR - Alentejo Region	01	0	0	1,531,000	704,624	0	201,660	129,700	2,262,390	171,000	3,097,000	2,900,000	197,000
AV - Aveiro Region	02	0	0	0	555,900	0	0	0	555,900	0	555,900	555,900	0
BE - Beja Region	03	0	0	0	0	0	0	0	0	0	0	0	0
BR - Braga Region	04	0	0	0	0	0	0	0	0	0	0	0	0
BS - Bragança Region	05	0	0	0	0	0	0	0	0	0	0	0	0
CA - Cadiz Region	06	0	0	0	0	0	0	0	0	0	0	0	0
CE - Castelo Branco Region	07	0	0	0	0	0	0	0	0	0	0	0	0
CO - Coimbra Region	08	0	0	0	0	0	0	0	0	0	0	0	0
CR - Coruña Region	09	0	0	0	0	0	0	0	0	0	0	0	0
CU - Cádiz Region	10	0	0	0	0	0	0	0	0	0	0	0	0
EV - Évora Region	11	0	0	0	0	0	0	0	0	0	0	0	0
FA - Faro Region	12	0	0	0	0	0	0	0	0	0	0	0	0
FE - Feixas Region	13	0	0	0	0	0	0	0	0	0	0	0	0
FM - Fátima Region	14	0	0	0	0	0	0	0	0	0	0	0	0
FM - Fátima Region	15	0	0	0	0	0	0	0	0	0	0	0	0
FM - Fátima Region	16	0	0	0	0	0	0	0	0	0	0	0	0
FM - Fátima Region	17	0	0	0	0	0	0	0	0	0	0	0	0
FM - Fátima Region	18	0	0	0	0	0	0	0	0	0	0	0	0
FM - Fátima Region	19	0	0	0	0	0	0	0	0	0	0	0	0
FM - Fátima Region	20	0	0	0	0	0	0	0	0	0	0	0	0
FM - Fátima Region	21	0	0	0	0	0	0	0	0	0	0	0	0
FM - Fátima Region	22	0	0	0	0	0	0	0	0	0	0	0	0
FM - Fátima Region	23	0	0	0	0	0	0	0	0	0	0	0	0
FM - Fátima Region	24	0	0	0	0	0	0	0	0	0	0	0	0
FM - Fátima Region	25	0	0	0	0	0	0	0	0	0	0	0	0
FM - Fátima Region	26	0	0	0	0	0	0	0	0	0	0	0	0
FM - Fátima Region	27	0	0	0	0	0	0	0	0	0	0	0	0
FM - Fátima Region	28	0	0	0	0	0	0	0	0	0	0	0	0
FM - Fátima Region	29	0	0	0	0	0	0	0	0	0	0	0	0
FM - Fátima Region	30	0	0	0	0	0	0	0	0	0	0	0	0
FM - Fátima Region	31	0	0	0	0	0	0	0	0	0	0	0	0
FM - Fátima Region	32	0	0	0	0	0	0	0	0	0	0	0	0
FM - Fátima Region	33	0	0	0	0	0	0	0	0	0	0	0	0
FM - Fátima Region	34	0	0	0	0	0	0	0	0	0	0	0	0
FM - Fátima Region	35	0	0	0	0	0	0	0	0	0	0	0	0
FM - Fátima Region	36	0	0	0	0	0	0	0	0	0	0	0	0
FM - Fátima Region	37	0	0	0	0	0	0	0	0	0	0	0	0
FM - Fátima Region	38	0	0	0	0	0	0	0	0	0	0	0	0
FM - Fátima Region	39	0	0	0	0	0	0	0	0	0	0	0	0
FM - Fátima Region	40	0	0	0	0	0	0	0	0	0	0	0	0
FM - Fátima Region	41	0	0	0	0	0	0	0	0	0	0	0	0
FM - Fátima Region	42	0	0	0	0	0	0	0	0	0	0	0	0
FM - Fátima Region	43	0	0	0	0	0	0	0	0	0	0	0	0
FM - Fátima Region	44	0	0	0	0	0	0	0	0	0	0	0	0
FM - Fátima Region	45	0	0	0	0	0	0	0	0	0	0	0	0
FM - Fátima Region	46	0	0	0	0	0	0	0	0	0	0	0	0
FM - Fátima Region	47	0	0	0	0	0	0	0	0	0	0	0	0
FM - Fátima Region	48	0	0	0	0	0	0	0	0	0	0	0	0
FM - Fátima Region	49	0	0	0	0	0	0	0	0	0	0	0	0
FM - Fátima Region	50	0	0	0	0	0	0	0	0	0	0	0	0
FM - Fátima Region	51	0	0	0	0	0	0	0	0	0	0	0	0
FM - Fátima Region	52	0	0	0	0	0	0	0	0	0	0	0	0
FM - Fátima Region	53	0	0	0	0	0	0	0	0	0	0	0	0
FM - Fátima Region	54	0	0	0	0	0	0	0	0	0	0	0	0
FM - Fátima Region	55	0	0	0	0	0	0	0	0	0	0	0	0
FM - Fátima Region	56	0	0	0	0	0	0	0	0	0	0	0	0
FM - Fátima Region	57	0	0	0	0	0	0	0	0	0	0	0	0
FM - Fátima Region	58	0	0	0	0	0	0	0	0	0	0	0	0
FM - Fátima Region	59	0	0	0	0	0	0	0	0	0	0	0	0
FM - Fátima Region	60	0	0	0	0	0	0	0	0	0	0	0	0
FM - Fátima Region	61	0	0	0	0	0	0	0	0	0	0	0	0
FM - Fátima Region	62	0	0	0	0	0	0	0	0	0	0	0	0
FM - Fátima Region	63	0	0	0	0	0	0	0	0	0	0	0	0
FM - Fátima Region	64	0	0	0	0	0	0	0	0	0	0	0	0
FM - Fátima Region	65	0	0	0	0	0	0	0	0	0	0	0	0
FM - Fátima Region	66	0	0	0	0	0	0	0	0	0	0	0	0
FM - Fátima Region	67	0	0	0	0	0	0	0	0	0	0	0	0
FM - Fátima Region	68	0	0	0	0	0	0	0	0	0	0	0	0
FM - Fátima Region	69	0	0	0	0	0	0	0	0	0	0	0	0
FM - Fátima Region	70	0	0	0	0	0	0	0	0	0	0	0	0
FM - Fátima Region	71	0	0	0	0	0	0	0	0	0	0	0	0
FM - Fátima Region	72	0	0	0	0	0	0	0	0	0	0	0	0
FM - Fátima Region	73	0	0	0	0	0	0	0	0	0	0	0	0
FM - Fátima Region	74	0	0	0	0	0	0	0	0	0	0	0	0
FM - Fátima Region	75	0	0	0	0	0	0	0	0	0	0	0	0
FM - Fátima Region	76	0	0	0	0	0	0	0	0	0	0	0	0
FM - Fátima Region	77	0	0	0	0	0	0	0	0	0	0	0	0
FM - Fátima Region	78	0	0	0	0	0	0	0	0	0	0	0	0
FM - Fátima Region	79	0	0	0	0	0	0	0	0	0	0	0	0
FM - Fátima Region	80	0	0	0	0	0	0	0	0	0	0	0	0
FM - Fátima Region	81	0	0	0	0	0	0	0	0	0	0	0	0
FM - Fátima Region	82	0	0	0	0	0	0	0	0	0	0	0	0
FM - Fátima Region	83	0	0	0	0	0	0	0	0	0	0	0	0
FM - Fátima Region	84	0	0	0	0	0	0	0	0	0	0	0	0
FM - Fátima Region	85	0	0	0	0	0	0	0	0	0	0	0	0
FM - Fátima Region	86	0	0	0	0	0	0	0	0	0	0	0	0
FM - Fátima Region	87	0	0	0	0	0	0	0	0	0	0	0	0
FM - Fátima Region	88	0	0	0	0	0	0	0	0	0	0	0	0
FM - Fátima Region	89	0	0	0	0	0	0	0	0	0	0	0	0
FM - Fátima Region	90	0	0	0	0	0	0	0	0	0	0	0	0
FM - Fátima Region	91	0	0	0	0	0	0	0	0	0	0	0	0
FM - Fátima Region	92	0	0	0	0	0	0	0	0	0	0	0	0
FM - Fátima Region	93	0	0	0	0	0	0	0	0	0	0	0	0
FM - Fátima Region	94	0	0	0	0	0	0	0	0	0	0	0	0
FM - Fátima Region	95	0	0	0	0	0	0	0	0	0	0	0	0
FM - Fátima Region	96	0	0	0	0	0	0	0	0	0	0	0	0
FM - Fátima Region	97	0	0	0	0	0	0	0	0	0	0	0	0
FM - Fátima Region	98	0	0	0	0	0	0	0	0	0	0	0	0
FM - Fátima Region	99	0	0	0	0	0	0	0	0	0	0	0	0
FM - Fátima Region	100	0	0	0	0	0	0	0	0	0	0	0	0



WEST DALY REGIONAL COUNCIL

FOR THE WADEYE LOCAL AUTHORITY OF 17 JULY 2018

Report for Agenda Item No 7

Prepared by **Rebecca Purser, Manager Corporate**

Local Authority Action Items Update

Purpose

To provide Local Authority Members with an update on progress of action items for local authority projects.

Impact for Council

Information purposes only.

Recommendation

- 1. That the Local Authority receives and notes the action items update.**

Attachments

- 1 LA Projects**

Regional Plan 2017/18 - Priorities highlighted by the Local Authority

WADEYE - THAMURBURU/PINDI PINDI WARD

Sport and Recreation Infrastructure

Children's playground equipment

Community Safety Infrastructure

Date	Project	Action	Progress	Budget/Approved Amount	Actual Amount	Comments
LA Meeting held 18 July 2017						
	Playground equipment for Manthathpe including soft-fall	Completed	STC Farmbuild will be placing fireproof/flamable proof equipment	\$25,000.00		Completed
	Pedestrian Crossing/Wombats	Completed	4 have been installed along Perdiert Street	\$33,858.00		Completed
	CCTV for the Pool	Completed		\$3,944	\$3,944.00	Completed
	Street Lighting Repairs	Completed				Completed
	Manthathpe Walk Way	Quotes Sourced - awaiting LA approval 17/4/18 and then Council approval 26/4/18	Refer to LA Meeting 9/5/18			Completed
	Shade Shelters for Main Oval (x3)	Council approved 25/10/17	Waiting for installation from Countrywide	\$36,699.00		Completed
	Softball Oval - fence	Council approved 21.2.18	Purchase order raised 4038	\$21,217.50 + \$1500 grant from Warren Snowden's office	\$36,217.50	Completed
	Median Strip Irrigation		DJ Electrical to provide work scope and recommendation			Inspected by "Water Dynamics" 02/07/18 and deemed beyond recommissioning. A quote is being prepared for replacement
	Softball Oval - Leveling		TDC will commence works after fence has been installed			Upon review of levelling quote from TDC it is not viable to use them. Seek approval from Local Authority to dress with top-soil and seed. Not expected to exceed existing approved amount
LA Meeting held 17 October 2017						
	Road Signage (ie: speed/crossings)	Council approved 21.2.18	Purchase order raised	\$1,896.84		Completed

	Light Pole Access Prevention (Manthathpe Crossing)	Quotes being sourced	Awaiting quotes as at 11/7/18				Lights received and awaiting installation
	Seek advice from Victims of Crime for Project Funding up to \$10,000.00	Application approved for Solar Lights					
LA Meeting held 8 December 2017							
	One Sentinel 50 LED light outside Manthathpe Store	Council Approved 13/12/17 -	Purchase order raised - Waiting for DI Electrical to commence works	\$4,057.00			
	Speed Hump/Pedestrian Crossing in front of Manthathpe Store	Council Approved 13/12/17 -	Purchase order raised - Waiting for STC to commence works	\$9,822.20			Completed
	6 calming wombats around Nilinh, Manthathpe and Wadeye	Council Approved 13/12/17 -	Purchase order raised - waiting for TDC to commence works	\$12694 x 6 - Total \$76,164.00	\$76,164.00		Completed
LA Meeting held 20 February 2018							
LA requested quotes be obtained for the following projects							
	Water Bubblers along main street and around the oval	Quotes Sourced - awaiting LA approval 17/4/18 and then Council approval 26/4/18	Approved by Council 18/5/18 - see below for further updates				See below for further updates
	Playgrounds at Nilinh and Manthathpe including a BBQ area/seating/bubblers	Quotes Sourced - awaiting LA approval 17/4/18 and then Council approval 26/4/18	NOT approved - LA required further design options - see below for further updates				See below for further updates
	Seating around the oval	Quotes Sourced - awaiting LA approval 17/4/18 and then Council approval 26/4/18	Approved by Council 18/5/18 - see below for further updates				See below for further updates
	Shade trees	Quotes Sourced - awaiting LA approval 17/4/18 and then Council approval 26/4/18	Approved by Council 18/5/18 - see below for further updates				See below for further updates
	Additional concrete speed humps around Manthathpe	Quotes Sourced - awaiting LA approval 17/4/18 and then Council approval 26/4/18	Approved by Council 18/5/18 - see below for further updates				See below for further updates
LA Meeting held 9 May 2018							
	Description	Approval date	Progress	Approved amount	Actual amount		Completion date
	Wadeye Softball Oval Drainage Works	TDC Quote approved by Council 18/5/18	As mentioned above and awaiting quotation from Water Dynamics for softball irrigation.	\$28,992.70			
	Scoping Study for Walkway and Elevated Footbridge between Manthathpe and Wadeye	Nth Degree quote approved by Council 18/5/18	Nth Degree Engineering have conducted on site investigations on 11/7/18 and will be drawing up plans/scope of works in the near future.	50% of invoice from Nth Degree Engineering (in			
	Water Bubblers along main street and around the oval	\$50,000 Approved by Council 18/5/18	Further quotes to be sourced as quote supplied to LA/Council only allowed for 2 water bubblers - expected second quote 13/7/18	Up to \$50,000			
	Aluminium Bench Seats (20) around the main oval + concrete for installation purposes	Draffin quote 21/7/20 approved by Council 18/5/18	Purchase order not yet raised as at 11/7/18	\$6297.50 (seats) + \$1,000 (concrete)			
	Shade trees around oval and main street	TDC 24/2/18 quote approved by Council 18/5/18	Purchase order not yet raised as at 11/7/18	\$2,475.00			
	Concrete Speed Humps around Manthathpe, Nilinh, Creek Camp, Ben Street and Bantian Street	Approved by Council 18/5/18	Purchase order not yet raised as at 11/7/18	Up to \$50,000			
	Playgrounds at Nilinh and Manthathpe including a BBQ area/seating/bubblers	Not approved - Local Authority noted the information received and requests different design options be presented at the next local authority meeting	CSM to ensure quotes are included in LA meeting on 17/7/18				
LA Meeting held 17 July 2018							
	Description	Approval date	Progress	Approved amount	Actual amount		Completion date